



## Features

### Recorded Data

Vehicle Speed, Acceleration, Deceleration, Engine Speed, Throttle Position, ABS Event, Seat and Seat Occupied by Position, E-Master Switch, Service Brake, Park Brake, Time, Date and Engine hours.

### Seat Belt Indicator Module

Indicate a seat belt is not buckled by seat position. Small footprint, fits within three rocker switch positions.



6444-0000-00



6204-0000-00

# Vehicle Data Recorder

Meeting the requirements of NFPA 1901-2009, the new Vehicle Data Recorder collects essential data for your training needs. Reviewing the information is made easy with an intuitive computer application. Apply this data to your training programs to improve response times, driver awareness and seat belt safety.

**Weldon (A Division of Akron Brass)**  
**800.989.2718**

## Technical Specifications VDR

Operating Voltage	9-32v (12 or 24V)
Current Draw	0.8 to 1.1 amps
Operating Temperature	-40°C to +85°C
Electrical Protection	Load Dump, Jump Start, Reverse Polarity, ESD, Short to Ground

Connector A DTM06-12SA			Connector B DTM06-12SB		
A	INPUT	TYPE	B	INPUT	TYPE
1	Park Brake Status	Gnd/Batt	1	Seat Belt 1 Status	Gnd/Batt
2	Service Brake	Gnd/Batt	2	Seat Belt 2 Status	Gnd/Batt
3	E-master Status	Gnd/Batt	3	Seat Belt 3 Status	Gnd/Batt
4	CAN 2 – Lo	Lo	4	Seat Belt 4 Status	Gnd/Batt
5	CAN 1 – Lo	Lo	5	Seat Belt 5 Status	Gnd/Batt
6	V-MUX – B	Lo	6	Seat Belt 6 Status	Gnd/Batt
7	V-MUX – A	Hi	7	Occupancy 6 status	Gnd/Batt
8	CAN 1 – Hi	Hi	8	Occupancy 5 status	Gnd/Batt
9	CAN 2 – Hi	Hi	9	Occupancy 4 status	Gnd/Batt
10	System Power	Vbatt	10	Occupancy 3 status	Gnd/Batt
11	Red Indicator	Gnd (Out)	11	Occupancy 2 status	Gnd/Batt
12	System Ground	GND	12	Occupancy 1 status	Gnd/Batt

### Application Notes:

Power and Ground; the ground wire should be run to a common point between the seat belt indicator and the VDR and if there are other V-MUX nodes. Preferably to a lone stud that is marked; V-MUX node grounds only. Items that may share the Vista display screen such as Cameras and GPS should also be grounded to the same common

Mating Connector	DTM-06 –3S
1	D+
2	D-
3	Ground
	Used to connect USB cable to VDR module

## Technical Specification Seat Belt Indicator

6204-0000-00

### Overview:

The Seat Belt Indicator module, connects to the VDR with a network cable The SBI receives the messages from the VDR on the different seat states and displays them accordingly.

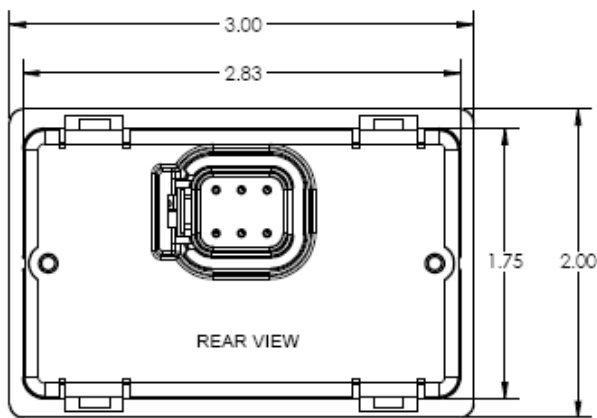

Operating Voltage	9.5 to 25v
Current Draw	.13 amp typical (.50 amp Max)
Operating Temperature	-40°C to 85°C
Electrical Protection	Load Dump, Jump Start, Reverse Polarity, ESD, Short to Ground
Accessory off Current	60 uA typical at 13V
Dimensions	1 3/16" H x 4 3/4 W X 4 5/8" L
Weight	.41lb (184 g)

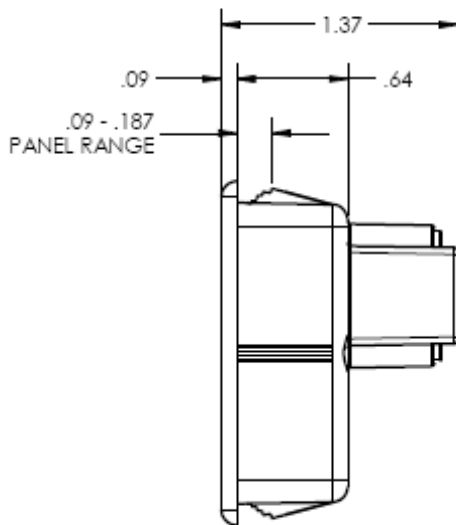

SIDE VIEW

Pin	Description
1	Comm A
2	Comm B
3	Ground
4	Power
5	Dimmer Input, 0-16v or 0-32v
6	Buzzer Output